

## Automatic Screw Feeder

# HS HS Series

(For manual operation)  
(For automatic assembly machines)

## Neji Taro aligns screws! The work efficiency of a production line will be dramatically improved.

- A single unit can handle different screw diameters by changing rails.
- Easy rail replacement.
- Screws are stably aligned and quickly fed to a line.
- Feeding speed can be adjusted depending on operational conditions.
- Some models can handle special screws.

### ● Model selection chart

Model	Neji Taro V		Neji Taro II		Neji Taro III		HSF
	For manual operation HSV series	For automatic assembly machines HSV-RB series	For manual operation HS series	For automatic assembly machines HS-RB series	For manual operation HS III series	For automatic assembly machines HS III-RB series	For manual operation HSF series
M1.0	● HSV-10	● HSV-10RB	—	—	● HS III-10	—	● HSF-10
M1.2	● HSV-12	● HSV-12RB	—	—	● HS III-12	—	● HSF-12
M1.4	● HSV-14	● HSV-14RB	—	—	● HS III-14	● HS III-14RB	● HSF-14
M1.7	● HSV-17	● HSV-17RB	—	—	● HS III-17	● HS III-17RB	● HSF-17
M2.0	● HSV-20	● HSV-20RB	—	—	● HS III-20	● HS III-20RB	● HSF-20
M2.3	● HSV-23	● HSV-23RB	—	—	● HS III-23	● HS III-23RB	—
M2.6	● HSV-26	● HSV-26RB	—	—	● HS III-26	● HS III-26RB	● HSF-26
M3.0	● HSV-30	● HSV-30RB	—	—	● HS III-30	● HS III-30RB	● HSF-30
M3.5	—	—	● HS-35	● HS-35RB	—	—	—
M4.0	—	—	● HS-40	● HS-40RB	—	—	—
M5.0	—	—	● HS-50	● HS-50RB	—	—	—
Screw transport type	Horizontal feeder Rotary escaper		Horizontal feeder Slide escaper (applicable only to automatic assembly machines)				

### ● Guide of specifications

The sizes (D), (H) and (L) of screws in the specifications refers to the following parts

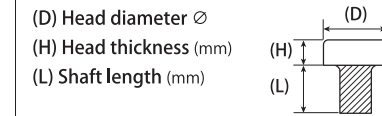

#### About dimensions of screw feeders

The dimensions in the left chart don't include projections and depressions. See the DXF files from HIOS website for more information. [www.hios.com](http://www.hios.com)

Go to DOWNLOAD -> DXF -> Automatic screw feeder

\* Special software is required to view DXF files.

#### Configuration of Screw Feeder

Main unit		Main unit only
Model		Main unit + applicable rail (1pc)
Replacement rail		Specify the rail's model number for ordering a rail.

## Neji Taro II HS Series



- A single unit can handle two screw diameters by changing rails.
- It has a large screw capacity of 150cc.
- Compatible with the suction type (for automatic assembly machines)

For manual operation

For automatic assembly machines

### HS Series



Models:  
HS-35 (M3.5) HS-40 (M4.0)  
HS-50 (M5.0)

### HS-RB Series



Models:  
HS-35RB (M3.5) HS-40RB (M4.0)  
HS-50RB (M5.0)

### ● Specifications

Classification	HS Series	HS-RB Series
DC Input	DC12V 500mA	
Dimensions (mm)	130(W)×215(D)×136(H)	134(W)×275(D)×136(H)
Weight (kg)	About 3.2kg (including the rail)	About 4.2kg (including the rail)
Screw capacity	150cc	
Overload protection circuit	Reverse rotation when overloaded, Forward rotation when restored	
Included Accessories:	1 installed standard rail, 1 guide plate, 1 hexagonal wrench (width across flats 2mm)	

\* If you purchase it, please refer to p.63 ordercode.

### ● Range of screws that can be supplied

Main unit	Model	Nominal screw diameter	(D)Head diameter(φ)	(H) Head thickness(mm)	(L)Shaft length(mm)	Replacement rail model number
HS-450	HS-35	M3.5	3.8-10.7	0.5 or more	5-18	HS-R35
	HS-40	M4.0	4.3-10.7	1.0 or more	5-18	HS-R40
	HS-50	M5.0	5.3-10.7	1.0 or more	6-18	HS-R50
HS-450RB	HS-35RB	M3.5	3.8-10.7	0.5 or more	5-18	HS-R35RB
	HS-40RB	M4.0	4.3-10.7	1.0 or more	5-18	HS-R40RB
	HS-50RB	M5.0	5.3-10.7	1.0 or more	6-18	HS-R50RB

## Neji Taro III HS III Series



- A single unit can handle different screw diameters by changing rails.
  - 8 screw diameters for the manual operation type, 6 screw diameters for the automatic assembly machines
- It feeds screws quickly; 120 screws per minute at average / M3 x 8 (for automatic assembly machines)
- Compatible with the suction type (for automatic assembly machines)

For manual operation

For automatic assembly machines

### HS III Series



Models:  
HS III-10 (M1.0) HS III-20 (M2.0)  
HS III-12 (M1.2) HS III-23 (M2.3)  
HS III-14 (M1.4) HS III-26 (M2.6)  
HS III-17 (M1.7) HS III-30 (M3.0)

### HS III-RB Series

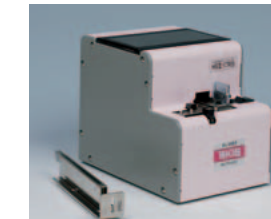

Models:  
HS III-14RB (M1.4) HS III-23RB (M2.3)  
HS III-17RB (M1.7) HS III-26RB (M2.6)  
HS III-20RB (M2.0) HS III-30RB (M3.0)

### ● Specifications

Classification	HS III Series	HS III-RB Series
DC Input	DC12V 500mA	
Dimensions (mm)	123(W)×181(D)×145(H)	123(W)×181(D)×144(H)
Weight (kg)	About 3kg (including the rail)	
Screw capacity	80cc	
Overload protection circuit	Reverse rotation when overloaded, Forward rotation when restored	
Included Accessories:	1 installed standard rail, 1 guide plate, 1 hexagonal wrench (width across flats 2mm), 1 gauge plate (0.35mm)	

\* If you purchase it, please refer to p.63 ordercode.

### ● Range of screws that can be supplied

Main unit	Model	Nominal screw diameter	(D)Head diameter(φ)	(H) Head thickness(mm)	(L)Shaft length(mm)	Replacement rail model number
HS III-300	HS III-10	M1.0	1.2-9	0.35 or more	1.6-10	HS-SR10
	HS III-12	M1.2	1.4-9	0.35 or more	1.8-10	HS-SR12
	HS III-14	M1.4	1.6-9	0.35 or more	2.0-10	HS-SR14
	HS III-17	M1.7	1.9-9	0.35 or more	2.3-10	HS-SR17
	HS III-20	M2.0	2.2-9	0.35 or more	2.6-20	HS-SR20
	HS III-23	M2.3	2.5-9	0.35 or more	2.9-20	HS-SR23
	HS III-26	M2.6	2.8-9	0.35 or more	3.2-20	HS-SR26
HS III-300 RB	HS III-30	M3.0	3.2-9	0.35 or more	3.6-20	HS-SR30
	HS III-14RB	M1.4	1.6-9	0.35 or more	2.0-10	HS-SR14RB
	HS III-17RB	M1.7	1.9-9	0.35 or more	2.3-10	HS-SR17RB
	HS III-20RB	M2.0	2.2-9	0.35 or more	2.6-20	HS-SR20RB
	HS III-23RB	M2.3	2.5-9	0.35 or more	2.9-20	HS-SR23RB
	HS III-26RB	M2.6	2.8-9	0.35 or more	3.2-20	HS-SR26RB
	HS III-30RB	M3.0	3.2-9	0.35 or more	3.6-20	HS-SR30RB

## Neji Taro V HSV Series

Multiple input type  
AC100V-240V RoHS CE

- A single unit can handle eight screw sizes by simply replacing the rail.
- The rotary escaper has been adopted to take out screws.
  - It has realized stable catching of screws by eliminating tangling of screws.
- Quickly catches unstable screws.
  - For examples, countersunk screws, screws with washer and thinner head screws can be handled
- Compatible with suction types (for automatic assembly machines)

For manual operation

For automatic assembly machines

### HSV Series



Models:  
HSV-10 (M1.0) HSV-20 (M2.0)  
HSV-12 (M1.2) HSV-23 (M2.3)  
HSV-14 (M1.4) HSV-26 (M2.6)  
HSV-17 (M1.7) HSV-30 (M3.0)

### HSV-RB Series



Models:  
HSV-10RB (M1.0) HSV-20RB (M2.0)  
HSV-12RB (M1.2) HSV-23RB (M2.3)  
HSV-14RB (M1.4) HSV-26RB (M2.6)  
HSV-17RB (M1.7) HSV-30RB (M3.0)

### ● Specifications

Classification	HSV Series	HSV-RB Series
Power Supply Input	AC100-240V (50/60Hz)	
(AC adapter) Output	DC15V 1A	
Dimensions (mm)	123(W)×181(D)×145(H)	
Weight (kg)	About 3kg (including the rail)	
Screw capacity	80cc	
Overload protection circuit	Reverse rotation when overloaded, Forward rotation when restored	
Included Accessories:	1 installed standard rail, 2 guide plates (1 installed), 1 hexagonal wrench (width across flats 2mm), 1 screwdriver (for timer adjustment), 2 escaper guides for robot (1 installed), 1 AC adapter	

\* AC adapter is included for overseas use.

### ● Range of screws that can be supplied

Main unit	Model	Nominal screw diameter	(D)Head diameter(φ)	(H) Head thickness(mm)	(L)Shaft length (mm)	Replacement rail model number
HSV	HSV-10	M1.0	1.2-9	0.35 or more	1.6-10	HSV-BI-10
	HSV-12	M1.2	1.4-9	0.35 or more	1.8-10	HSV-BI-12
	HSV-14	M1.4	1.6-9	0.35 or more	2.0-10	HSV-BI-14
	HSV-17	M1.7	1.9-9	0.35 or more	2.3-10	HSV-BI-17
	HSV-20	M2.0	2.2-9	0.35 or more	2.6-20	HSV-BI-20
	HSV-23	M2.3	2.5-9	0.35 or more	2.9-20	HSV-BI-23
	HSV-26	M2.6	2.8-9	0.35 or more	3.2-20	HSV-BI-26
HSV-RB	HSV-30	M3.0	3.2-9	0.35 or more	3.6-20	HSV-BI-30
	HSV-10RB	M1.0	1.2-9	0.35 or more	1.6-10	HSV-RI-10
	HSV-12RB	M1.2	1.4-9	0.35 or more	1.8-10	HSV-RI-12
	HSV-14RB	M1.4	1.6-9	0.35 or more	2.0-10	HSV-RI-14
	HSV-17RB	M1.7	1.9-9	0.35 or more	2.3-10	HSV-RI-17
	HSV-20RB	M2.0	2.2-9	0.35 or more	2.6-20	HSV-RI-20
	HSV-23RB	M2.3	2.5-9	0.35 or more	2.9-20	HSV-RI-23
	HSV-26RB	M2.6	2.8-9	0.35 or more	3.2-20	HSV-RI-26
	HSV-30RB	M3.0	3.2-9	0.35 or more	3.6-20	HSV-RI-30

## HSF Series

Multiple input type  
AC100V-240V RoHS CE

- A single unit can handle different screw diameters by changing rails.
  - HSF-01 handles 4 screw diameters, and HSF-02 handles 3 screw diameters.
- Low-profile design most suitable for cell production with the width of 55mm
- It can handle screws with thin heads by adjusting the sensor.

For manual operation

### HSF Series



Models:  
HSF-10 (M1.0) HSF-20 (M2.0)  
HSF-12 (M1.2) HSF-26 (M2.6)  
HSF-14 (M1.4) HSF-30 (M3.0)  
HSF-17 (M1.7)

### ● Specifications

		HSF Series	
Power supply Input	AC100-240V (50/60Hz)		
Power supply Output	DC15V 1A		
Dimensions (mm)	55(W)×205(D)×14.25(H)		
Weight (kg)	About 2.4kg (including the rail)		
Screw capacity	40cc		
Overload protection circuit	Reverse rotation when overloaded, Forward rotation when restored		
Included Accessories:	1 installed standard rail, 1 hexagonal wrench (width across flats 2mm)		

\* AC adapter is included for overseas use.

### ● Range of screws that can be supplied

Main unit	Model	Nominal screw diameter	(D)Head diameter(φ)	(H)Head thickness(mm)	(L)Shaft length(mm)	Replacement rail model number
HSF-01	HSF-10	M1.0	1.2-2.2	0.35 or more	1.6-16	HS-WR10
	HSF-12	M1.2	1.4-2.5	0.35 or more	1.8-16	HS-WR12
	HSF-14	M1.4	1.6-2.8	0.35 or more	2.0-16	HS-WR14
	HSF-17	M1.7	1.9-3.4	0.35 or more	2.3-16	HS-WR17
	HSF-20	M2.0	2.2-4.2	0.35 or more	2.6-16	HS-WR20
HSF-02	HSF-26	M2.6	2.8-5.0	0.35 or more	3.2-16	HS-WR26
	HSF-30	M3.0	3.2-5.8	0.35 or more	3.6-16	HS-WR30